



**Alpha ESS Co., Ltd.**

**Email:** philippines@alpha-ess.com    **Website:** www.alphaess.com



@AlphaESS



@AlphaESS



@AlphaESS



@AlphaESS



www.alphaess.com



# AlphaESS Asia Pacific



# YOUR SMART ENERGY

## 01 ABOUT ALPHAESS

- Who We Are

## 02 Residential ESS

- SMILE-X Series
- SMILE-G3 Series

## 03 C&I & Utility ESS

- STORION-M50
- STORION-LC-TB125-EX
- AlphaCS-H20/H40-MEA
- AlphaCS-H20-DC-LC-EX

## 04 Case Studies

- Residential ESS
- C&I and Utility ESS

# 01

## ABOUT ALPHAESS

• Who We Are

“Make clean energy  
accessible to everyone  
in the world.”





# WHO WE ARE

AlphaESS is a leading global green energy storage solution and service provider. With expertise in BMS, EMS, system integration, and cloud monitoring, we excel in providing tailored solutions for a wide range of applications, including residential, commercial & industrial, and utility-scale projects.

AlphaESS has 40+ subsidiaries and branches worldwide, including China, Germany, Australia, Italy, the United Kingdom, South Africa, Singapore, Malaysia, and more. With over 200,000 systems actively running across 130+ countries, we have built a comprehensive global supply chain and logistics network.

 **130 +**  
Countries & Regions

 **200,000 +**  
Systems Installed Globally

 **13 +**  
Years of Industry Experience

 **250 +**  
Patents in the ESS field

Discover more: [www.alphaess.com](http://www.alphaess.com)

  
**TOP 1**

Residential Energy Storage  
Provider in Australia

  
**TOP 5**

Residential Energy Storage  
Provider in Germany

  
**TOP 5**

Global Residential  
Storage Provider



The Most Recommended  
Brand in Germany



iF & Reddot & G-mark  
Design Award



TOP BRAND PV  
(STORAGE & INVERTERS )



# Global Production Bases

Powering Efficient Markets Worldwide

4

Production Centers



# Global Presence

Driving Production and Service Excellence

300+

Global Service Network

40+

Subsidiaries

4

R&D Centers



# Service Leading

Asia Pacific Premium Service Plan

10+

Dedicated Local Service Experts

1 on 1

Group Support

15 min

Fast Responds\*

3-Day

Fast RMA\*\*



Monthly Technical Training



On Site Service Support

\* Response time extends to one hour during non-business hours

\*\* Return Material Authorization

# AlphaCloud

A lifetime-free energy management and monitoring platform for all AlphaESS systems.

- 10-Second Real-Time Data Monitoring
- Open API Protocol



# AlphaPartner

Exclusive service platform for AlphaESS' parnters.

- **Installtion Self-Testing**  
Streamlined verification of meter and CT installation, battery power cables, and communication cables.
- **Commisioning Tool**  
Optimized first-installation commissioning process for efficiency.



# 02

## Residential ESS

4kW - 20kW

- SMILE-X Series
- SMILE-G3 Series

AlphaESS provides energy storage solutions for households.

With the AlphaCloud monitoring platform, users can fully enjoy the economic benefits and convenience of smart energy management.





01

## SMILE-X Series

Single Phase: 6kW / 12kW | 8-16kWh / 15-90kWh



### ***Empowering Homes with Adaptive, Resilient Energy***

- **All-Scenario Zero-Export Control**

The SMILE-X Series leverages All-Scenario Zero Export Control to eliminate reverse billing and keep every watt you generate.

- **Uninterrupted Performance in Unstable Grids**

Its advanced ride-through capability handles grid voltage and frequency swings without ever load degrading—ensuring uninterrupted, full-power delivery.

- **Reliability Even in Rainy Seasons**

Paired with dual backup function and ultra-low standby consumption, the SMILE-X Series offers smart, flexible load management to extend runtime for your most critical circuits.



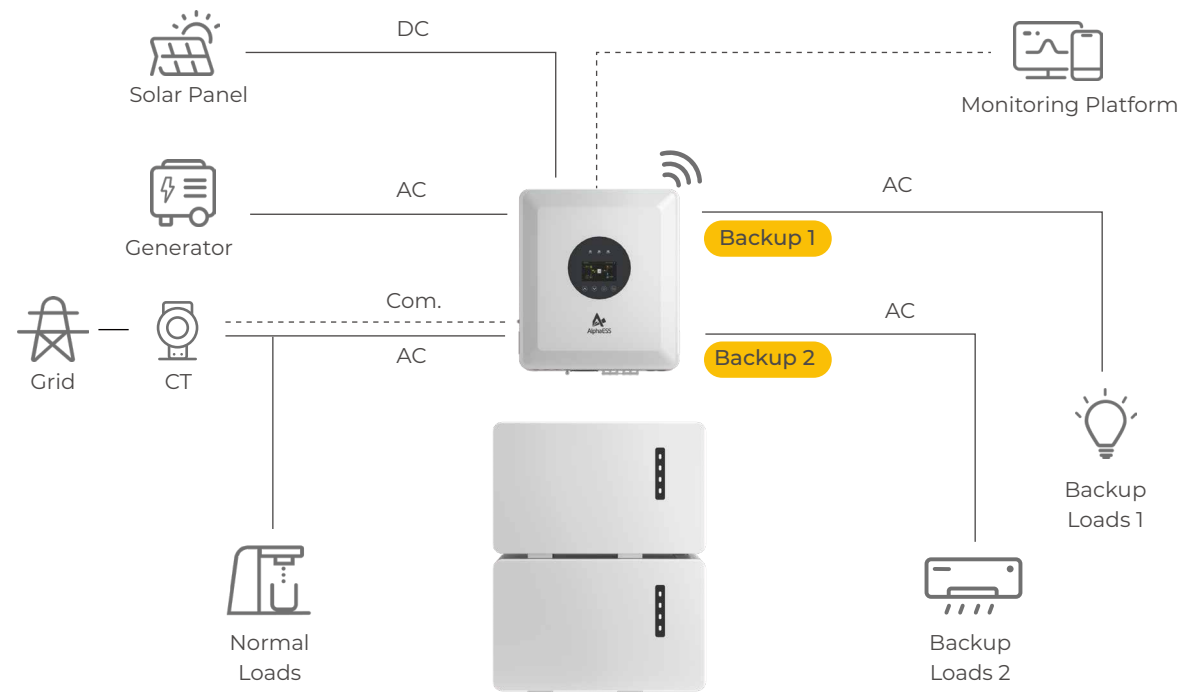

### System Power

6 kW / 12 kW  
Max 200% overload, 10s

### Battery Module

8 kWh, 25.6V, 314Ah  
15 kWh, 48V, 314Ah

### System Configuration

8 - 16 kWh (8 kWh module)  
15 - 90 kWh (15 kWh module)

### PV

166% PV oversizing  
**6 kW:** Two 16A input MPPTs, each MPPT has one string  
**12 kW:** Two 32A input MPPTs, each MPPT has two string

### Operating Condition

-25°C ~ 60°C  
IP21

### Warranty

5 years for system  
10 years for battery



## One System for Every Scenario



### Adapts to Any Setup

Support AC, DC, and Hybrid coupling

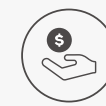

### Prevents Reverse Power Flow

Zero feed-in control  
eliminates unexpected grid charges



### Grid Fluctuations Adaptability

No load degrading during voltage or frequency instabilities



# Off-Grid Peace of Mind



<10ms



Seamless Switching When Blackouts

Ensures Reliability in  
Rainy Seasons



Dual Backup Design & Ultra-low  
Standby Power

Charges  
Rapidly with Solar



166% PV Oversizing & Wide MPPT Voltage

Handles  
Heavy Loads with Ease



200% Overloading for 10S

# User-Friendly Touchscreen

Empowering Every Step, From Setup to Daily Use



## Streamlined Setup

Pre-set parameters and step-by-step  
instructions for a hassle-free start.

## Instant Insights

Real-time status, history statistics, and  
alerts at a glance

## Intuitive Navigation

Simple menus and logical icons, making  
quick access to all settings.



02

## SMILE-G3 Series

Single Phase: 5kW | 3.8-15.2kWh / 9.3-37.2kWh

Three Phase: 4-20kW | 3.8-22.8kWh / 9.3-55.8kWh



## All-in-One Design ESS

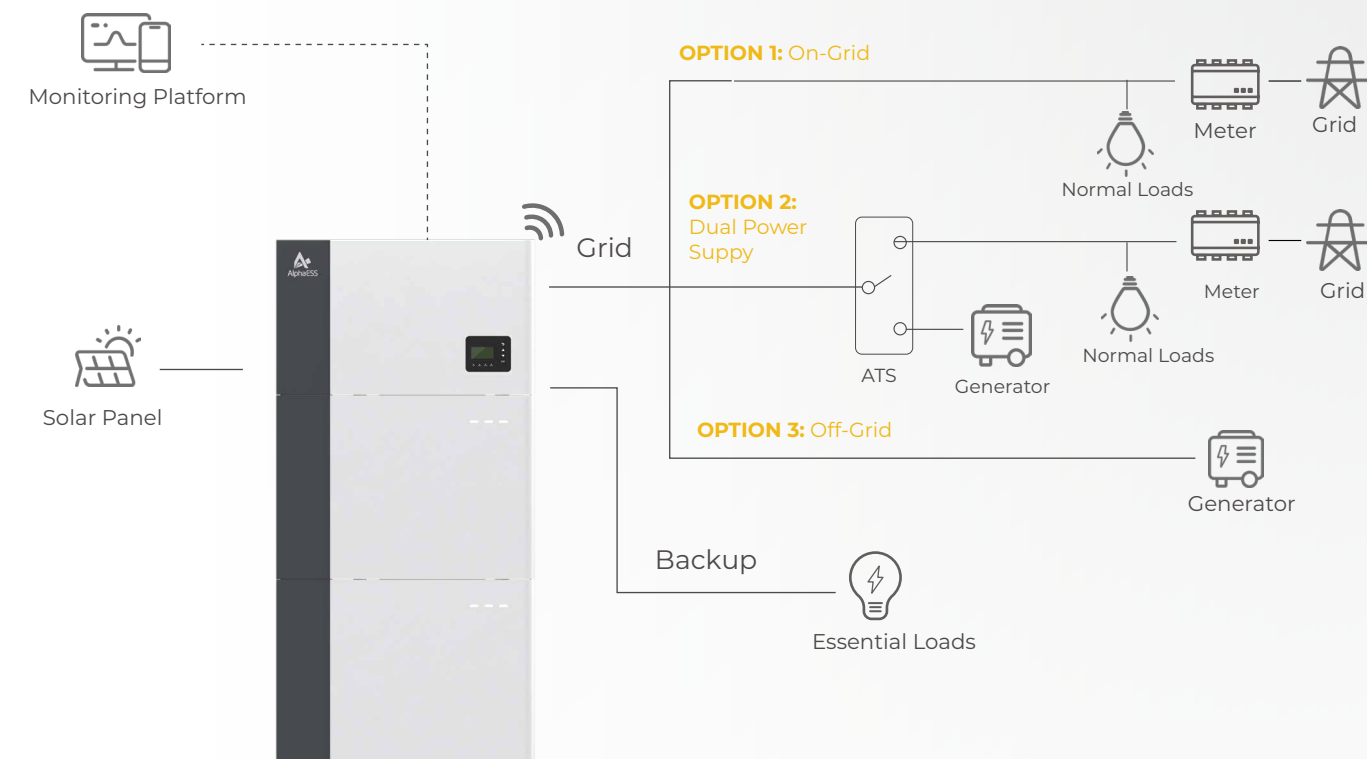

# SMILE-G3-S5

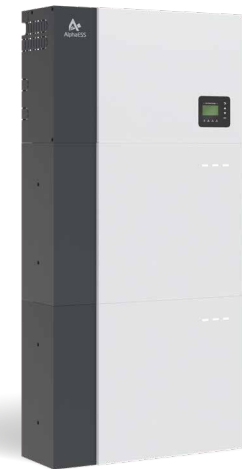

### System Power

5kW, single phase  
Max 200% overload@ 0.5s;  
150% overload @30s

### Battery Module

3.8kWh, 96V  
9.3kWh, 96V

### System Configuration

3.8 - 15.2 kWh (3.8kWh module)  
9.3 - 37.2 kWh(9.3kWh module)  
Max.3 inverter in parallel

### PV

2MPPTS, 2 strings, 16A Max. input  
current per MPPT  
200% PV oversizing

### Operating Condition

-25°C ~ 60°C  
IP65

### Warranty

5 years for system  
10 years for battery

# SMILE-G3-T4~T20



SMILE-G3-T4~T10

SMILE-G3-T12~T20

### System Power

4 - 20kW, three phase     150% unbalancing per phase  
**SMILE-G3-T4~T10:** Max 200% overload@1s; 150% overload@30s  
**SMILE-G3-T12~T20:** Max 150% overload@10s; 120% overload@10mins

### Battery Module

3.8kWh, 96V  
9.3kWh, 96V

### System Configuration

3.8 - 22.8kWh (3.8kWh module)  
9.3 - 55.8 kWh (9.3kWh module)  
Max.3 inverter in parallel

### PV

200% PV oversizing  
**SMILE-G3-T4~T10:** 3MPPTS, 3 strings, 16A Max. input current per MPPT  
**SMILE-G3-T12~T20:** 3MPPTS, 3 strings, 18A Max.input current per MPPT

### Operating Condition

-25°C ~ 60°C  
IP65

### Warranty

**SMILE-G3-T4~T10:** 10 years  
**SMILE-G3-T12~T20:** 5 years for system &  
10 years for battery



### Reliable & Safety

- Fast-suppression aerosol fire defense
- Bypass tech: Auto-Isolate fault units



### More Profits

- 200% PV Input
- Active balancing boots battery life



### Energy Independence

- UPS Power: <10ms switching, 200% overloading
- Dual power supply (grid & denerator)



### User-Friendly

- 7/24 Remote monitoring and mangement
- Max.28 time slots - flexible scheduling

# 03

## C&I and Utility ESS

50kW - 5000kW

- STORION-M50
- STORION-LC-TB125-EX
- AlphaCS-H20/H40-MEA
- AlphaCS-H20-DC-LC-EX

### C&I ESS

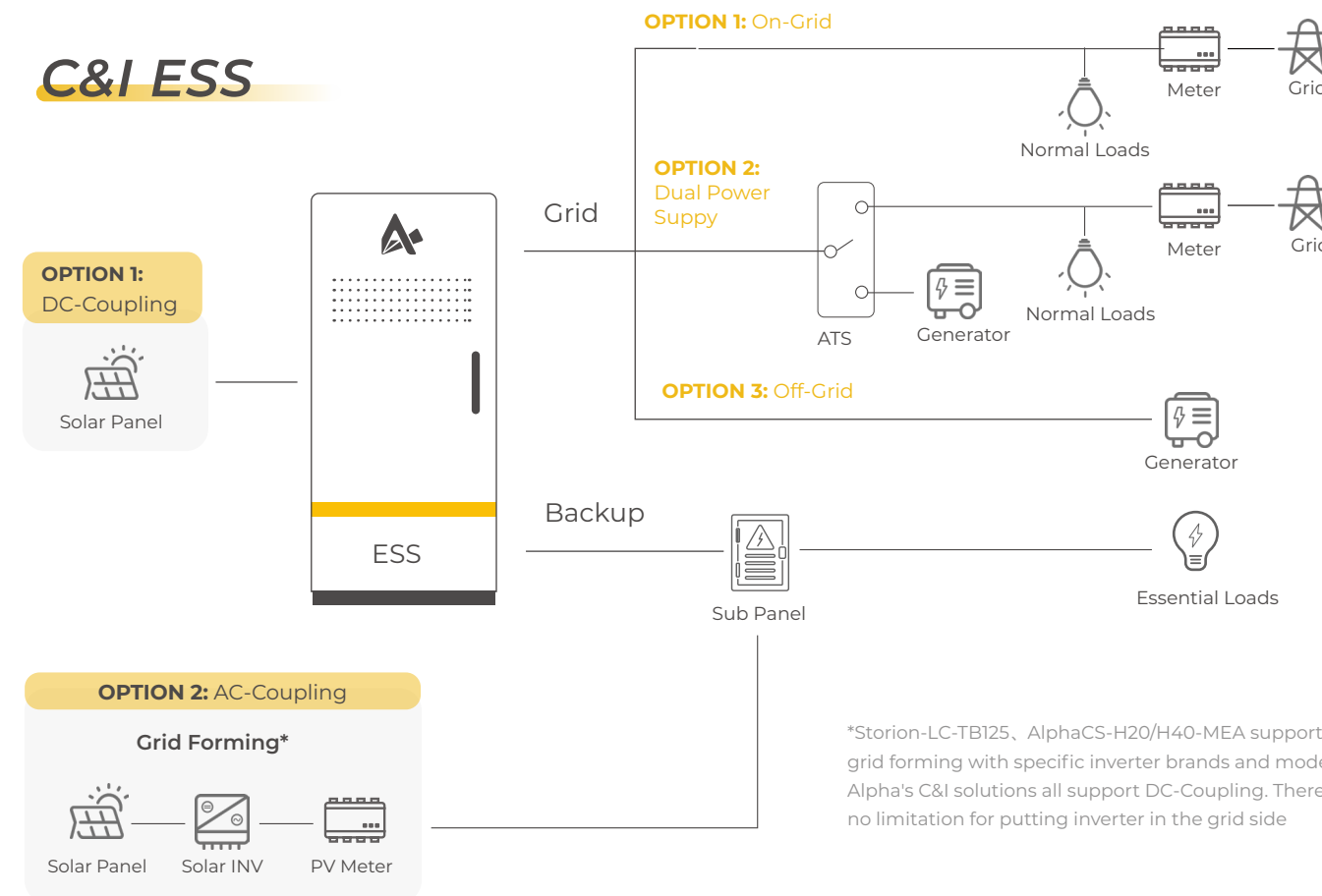

Max Self-Consumption



Feed-in Control



Timed Charging & Discharging



Generator Control



Backup



# 01

## STORION-M50

50kW | 108.45 - 217.04kWh



## ***World's First C&I Stackable Energy Storage System***

Powered by World's first Stackable Battery and Unique BMS functionality, the M50 series gives end to end customers with stability and more possibilities to handle varied needs. The modular design can easily fit into different site requirements with a simple stack and start installation.

### **• Effortless Installation with Modular Design**

The modular design ensures seamless adaptation to various site requirements, enabling a simple stack-and-start installation process.

### **• Advanced Software for Maximum Efficiency**

Our cutting-edge software protects against profit loss by addressing key challenges:

- Prevents capacity degradation due to SOC differences.
- Avoids system shutdowns caused by a single battery failure.
- Enhances savings on electricity bills with a more flexible EMS strategy.



# Stackable Design

## Streamline Every Step, from Convenient Transport to Effortless Scaling



### Flexible Transport

Truck, train, ship, or helicopter—choose your ideal logistics route.

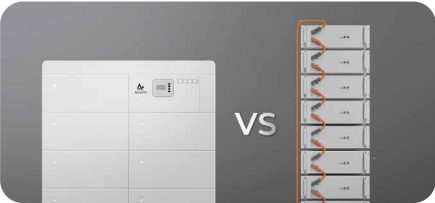

### Quick Installation

No battery rack and cable needed — just stack and start.



### Reliable Operation

AutoPilot BMS Technology ensures continuity by isolating faults.



### Boost Lifetime Output

Automated diagnostics & calibration for SOC consistency.

### Easy Expansion

Free you from time-consuming SOC balancing.



### System Power

50 kW  
160%, 10s overload capacity  
100% unbalance output

### Battery Module

12.06 kWh  
38.4 V  
314 Ah

### System Configuration

108.45 ~ 217.04 kWh

### PV

4MPPT 8 string  
40A input current  
200% PV oversizing

### Operating Condition

-25°C ~ 60°C  
IP66

### Warranty

5 years for system  
10 years for battery

02

## STORION-LC-TB125-EX

**System Power**

125 kW, 400V / 3P4W  
110% long term, 120% 1 min  
overload capacity  
100% Unbalance output

**Battery Module**

52.25 kWh  
166.4 V  
314 Ah

**System Configuration**

On grid: 24 in parallel  
Dual power: 5 in parallel

**DC coupling PV**

4 MPPT with 50A input  
200% PV oversizing

**Operating Condition**

-20°C ~ 60°C  
IP55

**Warranty**

5 years for system  
10 years for battery

03

## AlphaCS-H20/H40

**System Power**

187.5 - 1000 kW, 400V / 3P4W  
150%, 200ms overload  
100% Unbalance output

**Battery Module**

235.1 kWh  
748.8 V  
314 Ah

**System Configuration**

20FT: 705 - 1411 kwh  
40FT: 1646 - 2351 kWh

**PV**

DC couple: Max 3\*400KW DCDC  
AC couple: SG125K or GW 50/60K

**Operating Condition**

-25°C ~ 60°C  
IP54

**Warranty**

5 years for system  
10 years for battery

**Flexible configuration**

- Support backup(20ms switching)
- Support AC/DC coupling
- Support 2h-4h system requirement

**All in one design**

- Battery, PCS, EMS, heat management device,  
Fire-fighting device in one cabinet

**Easy Installation**

- Pre-wired design
- Eliminating internal wiring for batteries and inverters
- Turnkey solution

**Safety Design**

- 3-level battery monitoring
- Smoke & heat detection
- Aerosol and water fire fighting device



# 04 AlphaCS-H20-DC-LC-EX

## Solution for Power Plant

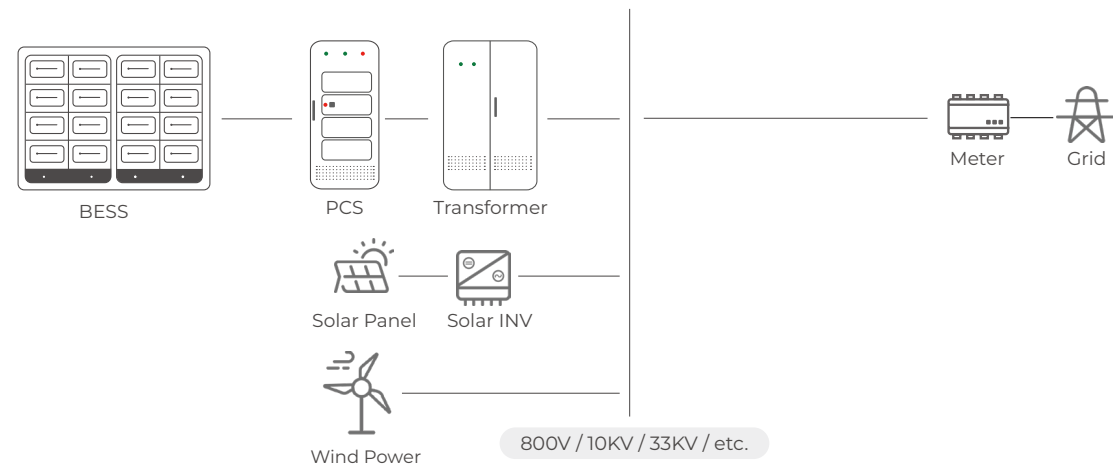

## Solution for Consumer Project

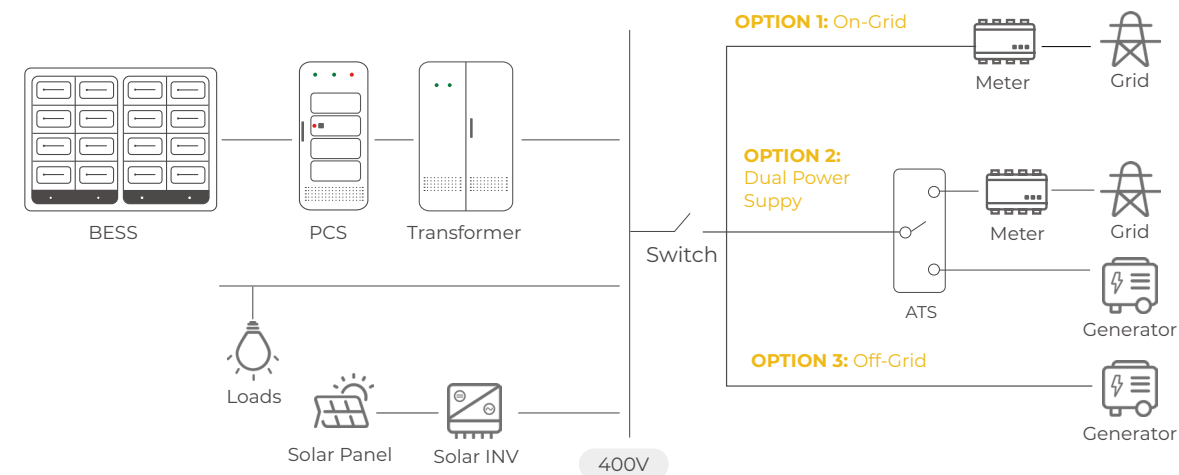

### Battery Module

372.5kWh / 417.9kWh  
1331.2V  
280 / 314Ah

### Capacity Configuration

2609 - 3354kWh  
4179 - 5015kWh

### PCS Power

1075 - 5000kW  
AC 690V / 3P3W

### PV

AC couple solution

### Operating Condition

-35°C ~ 60°C  
IP54

### Warranty

5 years for system  
10 years for battery



### High Energy Density

- Max. 5015.9kWh in 20Ft container



### Safety Design

- 3-level battery monitoring
- Smoke & heat detection
- Aerosol and water fire fighting device



### Back-to-Back Installation to Improve Site Utilization

# 04

## CASE STUDIES

- Residential ESS
- C&I and Utility ESS

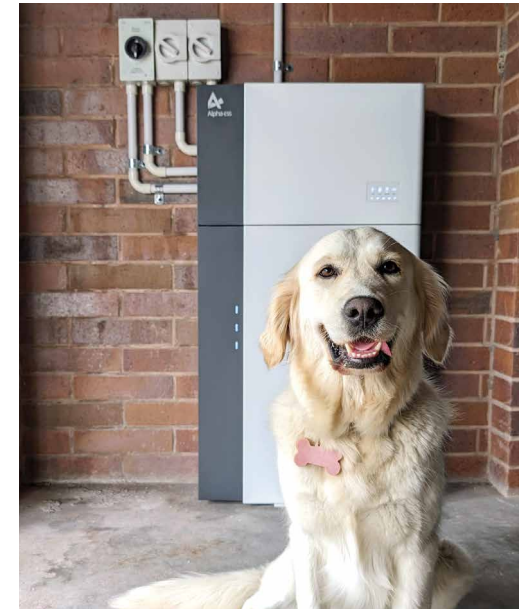



**140MW / 280MWh + 80MW / 160MWh**

Peak Shaving and Frequency Regulation  
Inner Mongolia, China





**100kW / 250kWh**

PV + Storage + Off-Grid  
Moomba, South Australia

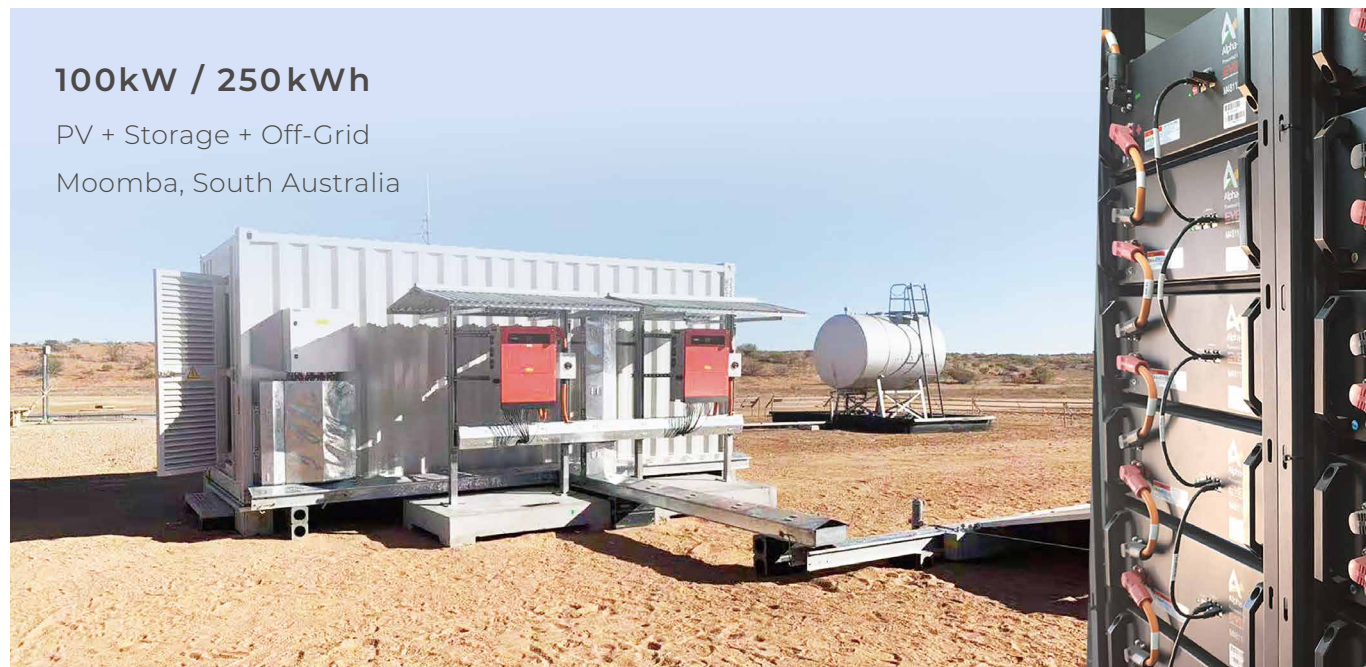

**100kW / 670kWh**

PV + Storage + Microgrid  
Fremantle, Western Australia



**1 50kW / 200kWh**  
PV + Storage  
Perth, Western Australia

**2 50kW - 100kW /  
100kWh - 300kWh**  
Solar-Battery-Diesel  
Microgrid System  
Myanmar, Southeast Asia

**3 100kW / 206kWh**  
PV + Storage + Genset  
Abu Dhabi, UAE

**4 500kW / 1MWh**  
PV + Storage + Genset  
Zimbabwe, Africa

Scan the QR code  
for more details

